

More than casting...

[www.jupalco.com](http://www.jupalco.com)



Jupalco Oy - tel. +358 - 9 - 4250 560  
myynti@jupalco.com - [www.jupalco.com](http://www.jupalco.com)

- **Founded:** 1990
- **Specialized:** To design, produce and supply access covers and frames to different purposes. To produce component castings from grey and nodular cast iron and carbonsteel up to stainless steel.
- **Main marketing areas:** Finland, Baltic and Nordic countries.
- **Range:** Working with municipal sector and HVAC Engineering.
- **Main products:** Access covers and gratings from grey and nodular iron. Component castings for industrial clients.



.....High quality according to EN 124 -standard  
.....Contact surfaces machined according to EN 124 -standard  
.....Assembly deepnes according to EN 124 -standard

- **Our mission:** Beside our own products we produce and supply innovative castings according to our client's drawings.
- **Our values:**
  - high level costumer service and care
  - realibility
  - cost efficient production
  - high quality of products
  - innovative working methods
  - flexible logistics and stock management
  - well organized quality control
- **Our Vision:** We want to be an innovative company and design new solutions of castings for our client's needs. Our mission is to be a reliable supplier for our clients.

- **Component castings:**

We produce component castings from different material grades to fulfil our customer's needs. Here are some examples:

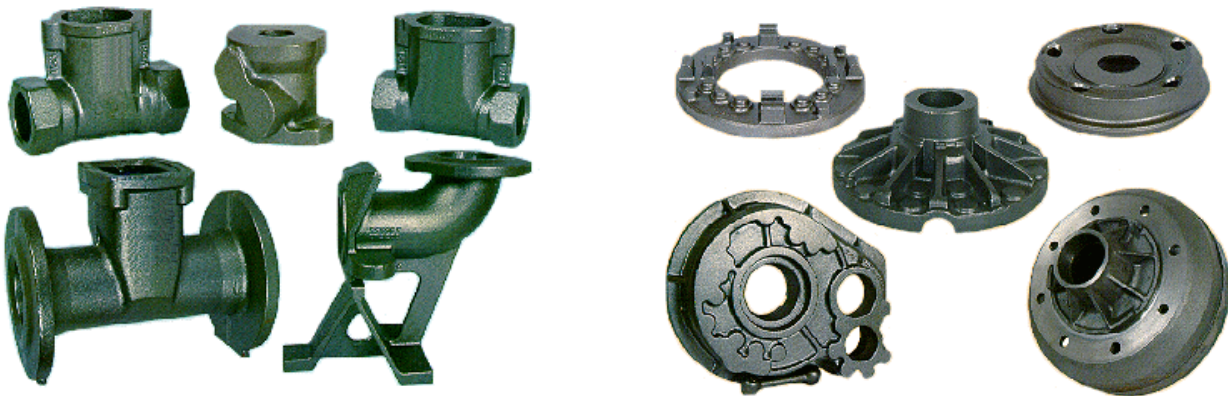

- **Jupalco access covers, gratings and frames for municipal purposes:**

In our stock we have several models of access covers and frames in grade EN GJL250. We also produce covers and frames in grade EN GJL500.

Here are some examples:





- **Jupalco manhole covers and frames for cable and pumping station purposes:**

**We produce several kinds of cable and pumping station access covers and frames according to EN124 standard in classes: A15, B125, C250, D400, E600, F900.**

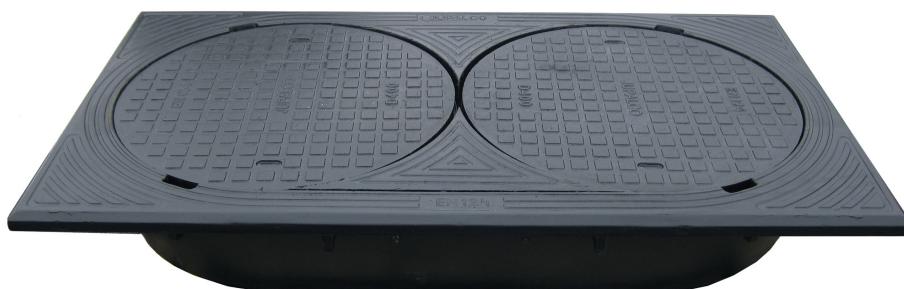

- **Our future plants:**

**We are continually keeping our eyes open for possibilities to widen our selection in the future. We want to develop our function, know-how and product selection for the benefit of our clients and ourselves now and in the future.**

### **Contact information**

**Jukka Palmu**  
managing director

tel. +358 - 9 - 4250 5640  
mobile + 358 400 242 003  
e-mail: [jukka.palmu@jupalco.com](mailto:jukka.palmu@jupalco.com)

**Mikko Palmu**  
sales

tel. +358 - 9 - 4250 5610  
mobile +358 400 318 003  
e-mail: [mikko.palmu@jupalco.com](mailto:mikko.palmu@jupalco.com)

**Office address:**  
**Tulvaniityntie 20, FIN-01680 VANTAA, FINLAND**